

* Agreed amendment with Pollution

(Part A) Application for an existing licence to be converted to a premises licence under the Licensing Act 2003 and (Part B) application to vary the premises licence simultaneously

PLEASE READ THE FOLLOWING INSTRUCTIONS FIRST

Before completing this form please read the guidance notes at the end of the form. If you are completing this form by hand please write legibly in block capitals. In all cases ensure that your answers are inside the boxes and written in black ink. Use additional sheets if necessary.

You may wish to keep a copy of the completed form for your records.

I/We Peter Jon Roberts and Christine Tania Roberts

apply to convert an existing licence to a premises licence under Schedule 8 to the Licensing Act 2003 for the premises described in Part A1 below

Part A1 – Premises Details

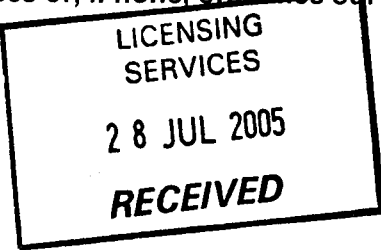
Postal address of premises or, if none, ordnance survey map reference or description The Crown Inn Old Christchurch Road Everton Lymington			
			
Post town	Lymington	Post code	SO41 0JJ

Telephone number of premises (if any)	01590 642655
Non-domestic rateable value of premises	£20750

Part A2 - Applicant Details

Please state the capacity in which you are applying to convert your existing licence

Please tick

- a) An individual or individuals please complete section (A)
- b) a person other than an individual
- i. as a limited company please complete section (B)
- ii. as a partnership please complete section (B)
- iii. as an unincorporated association or please complete section (B)
- iv. other (for example a statutory corporation) please complete section (B)
- c) a recognised club please complete section (B)

- d) a charity please complete section (B)
- e) the proprietor of an educational establishment please complete section (B)
- f) a health service body please complete section (B)
- g) a person who is registered under Part 2 of the Care Standards Act 2000 (c14) in respect of an independent hospital please complete section (B)
- h) the chief officer of police of a police force in England and Wales please complete section (B)

(A) INDIVIDUAL APPLICANTS (fill in as applicable)

Mr <input checked="" type="checkbox"/>	Mrs <input type="checkbox"/>	Miss <input type="checkbox"/>	Ms <input type="checkbox"/>	Other Title (for example, Rev)	
Surname Roberts			First names Peter Jon		
I am 18 years old or over					<input checked="" type="checkbox"/> Please tick yes
Current postal address if different from premises address					
Post Town		Postcode			
Daytime contact telephone number					
E-mail address (optional)					

SECOND INDIVIDUAL APPLICANT (IF APPLICABLE)

Mr <input type="checkbox"/>	Mrs <input checked="" type="checkbox"/>	Miss <input type="checkbox"/>	Ms <input type="checkbox"/>	Other Title (for example, Rev)	
Surname Roberts			First names Christine Tania		
I am 18 years old or over					<input checked="" type="checkbox"/> Please tick yes
Current postal address if different from premises address		20 Richmond Park Road Bournemouth Dorset			
Post Town	Bournemouth	Postcode	BH8 8TG		
Daytime contact telephone number		01202 301239			
E-mail address (optional)					

(B) OTHER APPLICANTS

Please provide name and registered address of applicant in full. Where appropriate please give any registered number. In case of a partnership or other joint nature (other than a body corporate), please give the name and address of each party concerned.

Name
Address
Registered number (where applicable)
Description of applicant (for example, partnership, company, unincorporated association etc.)
Telephone number (if any)
E-mail address (optional)

Part A3 - Operating Schedule

General description of premises (please read guidance note 1)

Detached purpose built early 19 th Century building with bar, restaurant, kitchen, beer cellar, garden to rear and parking for around 6 cars to the front, and licencees accomodation on first floor. Located in residential area of small village.
--

If 5,000 or more people attend the premises at any one time, please state the number

--

What existing licensable activities are authorised by your existing licence(s)?

Provision of regulated entertainment

Please tick Yes

- a) plays
- b) films
- c) indoor sporting events
- d) boxing or wrestling entertainment
- e) live music
- f) recorded music
- g) performances of dance
- h) anything of a similar description to that falling within (e), (f) or (g)

Provision of entertainment facilities for:

- i) making music
- j) dancing
- h) entertainment of a similar description to that falling within (i) or (j)

Provision of late night refreshment

Sale by retail of alcohol

- a) for consumption on the premises
- b) for consumption off the premises

Please state who you wish to be specified to be the premises supervisor under the new licence

Name

Peter Jon Roberts

Address

The Crown Inn Everton
Old Christchurch Road
Everton
Hampshire
SO41 0JJ

Personal Licence number, if known,

State any limitations on the hours during which you are permitted by your licence(s) or any additional authorities to conduct licensable activities, including the sale of alcohol.

Annual Indoor Public Entertainment Licence.
Permitted hours:- Monday - Saturday 20.30 - 22.30
Sunday 20.00 - 22.00
Maximum people 120
Condition 113 Noise control

folk and jazz only, a hood must be placed pm the mechanical air vent when music is played to prevent noise outbreak, an insulated board should be placed into the window recess of the fixed glazed window 'A' on plan attached to PEL when music is played and all entrance doors to the premises and windows must be kept closed in the course of all public entertainment functions.

Describe the conditions subject to which your existing licence(s) has/have been granted (please read guidance note 2):

a) General – all four licensing objectives (b,c,d,e)

None

b) The prevention of crime and disorder

None

c) Public safety

The pub complies with the maximum permitted number of persons stipulated in the Annual Indoor Entertainment licence.

d) The prevention of public nuisance

Please see conditions attached to current Indoor Public Entertainment Licence.

e) The protection of children from harm

Please tick Yes

- I have made or enclosed payment of the fee
- I have enclosed my existing licence(s) or a certified copy of each licence
- I have enclosed a plan of the premises
- I have sent copies of this application to the chief officer of police (please read guidance note 3)
- I have enclosed the consent form completed by the proposed premises supervisor, if relevant
- I have enclosed the consent of the justices' licence holder to my application, if relevant
- I understand that if I do not comply with the above requirements my application will be rejected

IT IS AN OFFENCE, LIABLE ON CONVICTION TO A FINE UP TO LEVEL 5 ON THE STANDARD SCALE, UNDER SECTION 158 OF THE LICENSING ACT 2003 TO MAKE A FALSE STATEMENT IN OR IN CONNECTION WITH THIS APPLICATION

Part A4 – Signatures (please read guidance note 4)

Signature of applicant or applicant's solicitor or other duly authorised agent. (Please read guidance note 5). **If signing on behalf of the applicant please state in what capacity.**

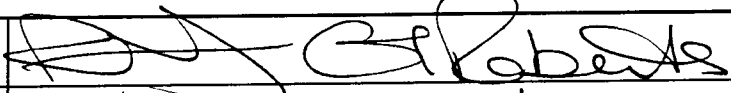
Signature	
Date	27 th July 05
Capacity	

For joint applications signature of 2nd applicant or 2nd applicant's solicitor or other authorised agent. (Please read guidance note 6). If signing on behalf of the applicant please state in what capacity.

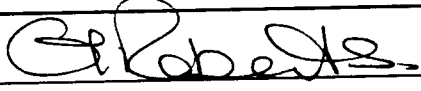
Signature	
Date	27 July 05
Capacity	

Contact name (where not previously given) and address for correspondence associated with this application (please read guidance note 7)			
Peter Jon Roberts The Crown Inn Old Christchurch Road Everton Hampshire			
Post town	Lymington	Post code	SO41 0JJ
Telephone number	01590 642655		
E-mail address (optional)			

IF YOU WISH TO APPLY SIMULTANEOUSLY FOR A VARIATION OF THE PREMISES LICENCE IF IT IS CONVERTED FROM YOUR EXISTING LICENCE(S) UNDER SECTION 34 OR 37 OF THE LICENSING ACT 2003, NOW COMPLETE PART B OF THIS FORM.

IF YOU DO NOT WISH TO APPLY SIMULTANEOUSLY FOR A VARIATION OF THE PREMISES LICENCE IF IT IS CONVERTED FROM YOUR EXISTING LICENCE(S), YOU SHOULD LEAVE PART B BLANK.

PART B - Application to vary a premises licence under the Licensing Act 2003

I/We Peter Jon Roberts and Christine Tania Roberts

[Insert name of applicant]

being the proposed premises licence holder of an existing licence to be converted under the terms of Schedule 8 to the Licensing Act 2003 apply to vary it under section 34 / section 37 of the Licensing Act 2003 (delete as applicable) for the premises described in Part A above.

Part B1 - Variation

Please tick

Do you want the proposed variation to have effect from the second appointed day?

If not when do you want the variation to take effect from

Day	Month	Year

Please describe briefly the nature of the proposed variation. (Please read guidance note 8)

The provision of live and recorded music inside the premises as the business plan from time to time in force requires. This music will be played one day a week, the application asks for 7 days a week in order to allow flexibility to accommodate both customers and availability of performers.

+ alcohol extension (up)

If your proposed variation would mean that 5,000 or more people are expected to attend the premises at any one time, please state the number expected to attend

Part B2 - Operating Schedule

Please complete those parts of the operating schedule which would be subject to change if this application to vary were successful.

What licensable activities do you now intend to conduct on the premises and/or at what varied times do you intend to conduct them ?

(please see section 1 of the Licensing Act 2003 and Schedule 1 to the Licensing Act 2003)

Provision of regulated entertainment

Please tick Yes

- | | |
|---|-------------------------------------|
| a) plays (if ticking yes, fill in box A) | <input type="checkbox"/> |
| b) films (if ticking yes, fill in box B) | <input type="checkbox"/> |
| c) indoor sporting events (if ticking yes, fill in box C) | <input type="checkbox"/> |
| d) boxing or wrestling entertainment (if ticking yes, fill in box D) | <input type="checkbox"/> |
| e) live music (if ticking yes, fill in box E) | <input checked="" type="checkbox"/> |
| f) recorded music (if ticking yes, fill in box F) | <input checked="" type="checkbox"/> |
| g) performances of dance (if ticking yes, fill in box G) | <input type="checkbox"/> |
| h) anything of a similar description to that falling within (e), (f) or (g) (if ticking yes, fill in box H) | <input type="checkbox"/> |

Provision of entertainment facilities:

- | | |
|---|--------------------------|
| i) making music (if ticking yes, fill in box I) | <input type="checkbox"/> |
| j) dancing (if ticking yes, fill in box J) | <input type="checkbox"/> |
| k) entertainment of a similar description to that falling within (i) or (j) (if ticking yes, fill in box K) | <input type="checkbox"/> |

Provision of late night refreshment (if ticking yes, fill in box L)

Sale by retail of alcohol (if ticking yes, fill in box M)

Please complete Part B3 on this form.

A

Plays Standard days and timings (please read guidance note 8)			Will the performance of a play take place indoors or outdoors or both – please tick (please read guidance note 9)	Indoors	<input type="checkbox"/>
				Outdoors	<input type="checkbox"/>
				Both	<input type="checkbox"/>
Day	Start	Finish	<u>Please give further details here</u> (please read guidance note 10)		
Mon					
Tue			<u>State any seasonal variations for performing plays</u> (please read guidance note 11)		
Wed					
Thur			<u>Non standard timings. Where you intend to use the premises for the performance of plays at different times to those listed in the column on the left, please list</u> (please read guidance note 12)		
Fri					
Sat					
Sun					

B

Films Standard days and timings (please read guidance note 8)			Will the exhibition of films take place indoors or outdoors or both – please tick (please read guidance note 9)	Indoors	<input type="checkbox"/>
				Outdoors	<input type="checkbox"/>
				Both	<input type="checkbox"/>
Day	Start	Finish	<u>Please give further details here</u> (please read guidance note 10)		
Mon					
Tue			<u>State any seasonal variations for the exhibition of films</u> (please read guidance note 11)		
Wed					
Thur			<u>Non standard timings. Where you intend to use the premises for the exhibition of films at different times to those listed in the column on the left, please list</u> (please read guidance note 12)		
Fri					
Sat					
Sun					

C

Indoor sporting events Standard days and timings (please read guidance note 8)			<u>Please give further details</u> (please read guidance note 10)
Day	Start	Finish	
Mon			<u>State any seasonal variations for indoor sporting events</u> (please read guidance note 11)
Tue			
Wed			
Thur			<u>Non standard timings. Where you intend to use the premises for indoor sporting events at different times to those listed in the column on the left, please list</u> (please read guidance note 12)
Fri			
Sat			
Sun			

D

Boxing or wrestling entertainment Standard days and timings (please read guidance note 8)			Will the boxing or wrestling entertainment take place indoors or outdoors or both – please tick (please read guidance note 9)	Indoors	<input type="checkbox"/>
				Outdoors	<input type="checkbox"/>
				Both	<input type="checkbox"/>
Day	Start	Finish	Please give further details here (please read guidance note 10)		
Mon					
Tue			State any seasonal variations for boxing or wrestling entertainment (please read guidance note 11)		
Wed					
Thur			Non standard timings. Where you intend to use the premises for boxing or wrestling entertainment at different times to those listed in the column on the left, please list (please read guidance note 12)		
Fri					
Sat					
Sun					

E

Live music Standard days and timings (please read guidance note 8)			Will the performance of live music take place indoors or outdoors or both – please tick (please read guidance note 9)	Indoors	<input checked="" type="checkbox"/>
				Outdoors	<input type="checkbox"/>
				Both	<input type="checkbox"/>
Day	Start	Finish	<u>Please give further details here</u> (please read guidance note 10) Live music will be provided on one night a week, the requested days are to allow for flexibility around customer demand and the availability of performers. The days to be fixed on this basis.		
Mon	20.30	22.30			
Tue	20.30	22.30	<u>State any seasonal variations for the performance of live music</u> (please read guidance note 11)		
Wed	20.30	22.30			
Thur	20.30	22.30	<u>Non standard timings. Where you intend to use the premises for the performance of live music at different times to those listed in the column on the left, please list</u> (please read guidance note 12)		
Fri	20.30	22.30			
Sat	20.30	22.30			
Sun	20.00	22.00			

F

Recorded music Standard days and timings (please read guidance note 8)			Will the playing of recorded music take place indoors or outdoors or both – please tick (please read guidance note 9)	Indoors	<input checked="" type="checkbox"/>
				Outdoors	<input type="checkbox"/>
				Both	<input type="checkbox"/>
Day	Start	Finish	<u>Please give further details here</u> (please read guidance note 10) As for the reply to section E.		
Mon	20.30	22.30			
Tue	20.30	22.30	<u>State any seasonal variations for playing recorded music</u> (please read guidance note 11)		
Wed	20.30	22.30			
Thur	20.30	22.30	<u>Non standard timings. Where you intend to use the premises for the playing of recorded music entertainment at different times to those listed in the column on the left, please list</u> (please read guidance note 12)		
Fri	20.30	22.30			
Sat	20.30	22.30			
Sun	20.00	22.00			

G

Performances of dance Standard days and timings (please read guidance note 8)			Will the performance of dance take place indoors or outdoors or both – please tick (please read guidance note 9)	Indoors <input type="checkbox"/>
				Outdoors <input type="checkbox"/>
				Both <input type="checkbox"/>
Day	Start	Finish	<u>Please give further details here</u> (please read guidance note 10)	
Mon				
Tue				
Wed			<u>State any seasonal variations for the performance of dance</u> (please read guidance note 11)	
Thur				
Fri			<u>Non standard timings. Where you intend to use the premises for the performance of dance entertainment at different times to those listed in the column on the left, please list</u> (please read guidance note 12)	
Sat				
Sun				

H

<p>Anything of a similar description to that falling within (e), (f) or (g) Standard days and timings (please read guidance note 8)</p>			<p><u>Please give a description of the type of entertainment you will be providing</u></p>		
Day	Start	Finish	<p><u>Will this entertainment take place indoors or outdoors or both – please tick</u> (please read guidance note 9)</p>	Indoors	<input type="checkbox"/>
Mon				Outdoors	<input type="checkbox"/>
				Both	<input type="checkbox"/>
Tue			<p><u>Please give further details here</u> (please read guidance note 10)</p>		
Wed					
Thur			<p><u>State any seasonal variations for entertainment of a similar description to that falling within (e), (f) or (g)</u> (please read guidance note 11)</p>		
Fri					
Sat			<p><u>Non standard timings. Where you intend to use the premises for the entertainment of similar description to that falling within (e), (f) or (g) at different times to those listed in the column on the left, please list</u> (please read guidance note 12)</p>		
Sun					

I

Provision of facilities for making music Standard days and timings (please read guidance note 8)			<u>Please give a description of the facilities for making music you will be providing</u>			
			Will the facilities for making music be indoors or outdoors or both – please tick (please read guidance note 9)			
			Indoors	<input type="checkbox"/>		
			Outdoors	<input type="checkbox"/>		
			Both	<input type="checkbox"/>		
Day	Start	Finish	<u>Please give further details here</u> (please read guidance note 10)			
Mon						
Tue						
Wed					<u>State any seasonal variations for the provision of facilities for making music</u> (please read guidance note 11)	
Thur						
Fri						
Sat					<u>Non standard timings. Where you intend to use the premises for provision of facilities for making music entertainment at different times to those listed in the column on the left, please list</u> (please read guidance note 12)	
Sun						

J

Provision of facilities for dancing Standard days and timings (please read guidance note 8)			Will the facilities for dancing be indoors or outdoors or both – please tick (please read guidance note 9)	Indoors	<input type="checkbox"/>
				Outdoors	<input type="checkbox"/>
				Both	<input type="checkbox"/>
Day	Start	Finish	<u>Please give further details here</u> (please read guidance note 10)		
Mon					
Tue			<u>State any seasonal variations for providing dancing facilities</u> (please read guidance note 11)		
Wed					
Thur			<u>Non standard timings. Where you intend to use the premises for the provision of facilities for dancing entertainment at different times to those listed in the column on the left, please list</u> (please read guidance note 12)		
Fri					
Sat					
Sun					

K

Provision of facilities for entertainment of a similar description to that falling within i or j Standard days and timings (please read guidance note 8)			<u>Please give a description of the type of entertainment facility you will be providing</u>		
Day	Start	Finish	<u>Will the entertainment facility be indoors or outdoors or both – please tick</u> (please read guidance note 9)	Indoors	<input type="checkbox"/>
Mon				Outdoors	<input type="checkbox"/>
				Both	<input type="checkbox"/>
Tue			<u>Please give further details here</u> (please read guidance note 10)		
Wed					
Thur			<u>State any seasonal variations for the provision of facilities for entertainment of a similar description to that falling within i or j</u> (please read guidance note 11)		
Fri					
Sat			<u>Non standard timings. Where you intend to use the premises for the provision of facilities for entertainment of a similar description to that falling within i or j at different times to those listed in the column on the left, please list</u> (please read guidance note 12)		
Sun					

L

Late night refreshment Standard days and timings (please read guidance note 8)			Will the provision of late night refreshment take place indoors or outdoors or both – please tick (please read guidance note 9)	Indoors	<input type="checkbox"/>
				Outdoors	<input type="checkbox"/>
				Both	<input type="checkbox"/>
Day	Start	Finish	<u>Please give further details here</u> (please read guidance note 10)		
Mon					
Tue					
Wed			<u>State any seasonal variations for the provision of late night refreshment</u> (please read guidance note 11)		
Thur					
Fri					
Sat			<u>Non standard timings. Where you intend to use the premises for the provision of late night refreshment at different times, to those listed in the column on the left, please list</u> (please read guidance note 12)		
Sun					

M

Supply of alcohol Standard days and timings (please read guidance note 8)			Will the supply of alcohol be for consumption (Please tick box) (please read guidance note 13)	On the premises	<input type="checkbox"/>
				Off the premises	<input type="checkbox"/>
				Both	<input checked="" type="checkbox"/>
Day	Start	Finish	<u>State any seasonal variations for the supply of alcohol</u> (please read guidance note 11)		
Mon	10.30	01.00			
Tue	10.30	01.00			
Wed	10.30	01.00			
Thur	10.30	01.00			
Fri	10.30	01.00			
Sat	10.30	01.00			
Sun	10.30	01.00	<u>Non-standard timings. Where you intend to use the premises for the supply of alcohol at different times to those listed in the column on the left, please list</u> (please read guidance note 12)		

IN ALL CASES PLEASE COMPLETE BOXES N, O, P and Q below

N

Please highlight any adult entertainment or services, activities, other entertainment or matters ancillary to the use of the premises that may give rise to concern in respect of children (please read guidance note 14)
None in relation to these premises other than those identified below.

O

Hours premises are open to the public Standard days and timings (please read guidance note 8)			State any seasonal variations (please read guidance note 11)
Day	Start	Finish	
Mon	10.30	01.00	
Tue	10.30	01.00	
Wed	10.30	01.00	
Thur	10.30	01.00	
Fri	10.30	01.00	
Sat	10.30	01.00	
Sun	10.30	01.00	Non standard timings. Where you intend to use the premises to be open to the public at different times from those listed in the column on the left, please list (please read guidance note 12)

P

Please identify any of the conditions, terms or restrictions currently imposed on the converted licence which you believe could be removed as a consequence of the proposed variation you are seeking

Q Please describe any additional steps that you intend to take in order to promote the four licensing objectives if the proposed variation is granted:

a) General – all four licensing objectives (b,c,d,e) (please read guidance note 15)

Pub managers and staff are informed of the Licensing Act 2003 objectives and statutory requirements to comply with all relevant provisions of the Act. No new steps have been identified in the risk assessment carried out by the licensee in relation to the four licensing objectives in relation to the proposed extension of the hours.

b) The prevention of crime and disorder

All staff are instructed by the licensee not to sell alcohol to drunken customers, nor to permit drunken and disorderly customers into the premises.

c) Public safety

The pub complies with Health & Safety & Fire Precautions regulations. Following risk assessment, preventive and control measures are in place to ensure the safety of members, guests, employees and entertainers while on the premises. The pub complies with advised capacity limits. Fire notices are posted and emergency exits are signed.

d) The prevention of public nuisance

When live or recorded music is played, the pub complies with the noise prevention measures identified in the Annual Indoor Entertainment Licence. Working with objective B facilitates the orderly and quiet dispersment of customers at the end of the evening. The extension of hours to enable diners to quietly finish their meal and drink up will allow a smooth and progressive emptying of the premises at the end of the evening.

e) The protection of children from harm

Children under 18 are only permitted into the pub in the dining areas and accompanied by an adult. All staff are instructed only to serve people they know to be over 18, and ask for proof of age if need be. All staff are instructed in the offence provisions of the Licensing Act 2003 relating to alcohol and the protection of children. Signs are displayed prohibiting the sale or supply of alcohol to children under 18.

Part B3 – Premises Supervisor

Full name of proposed designated premises supervisor

Peter Jon Roberts

Address of proposed designated premises supervisor

The Crown Inn
Old Christchurch Road
Everton
Hampshire
SO41 0JJ

Personal licence number of proposed designated premises supervisor, if any, and issuing authority of the personal licence, if applicable

Please tick Yes

- I enclose the consent form completed by the proposed premises supervisor
- I will give a copy of Part B3 of this application to the chief officer of police (section 37 of the Licensing Act 2003)
- I have sent copies of this application to vary (except Part B3) to responsible authorities and others where applicable (section 34 of the Licensing Act 2003)
- I understand that I must now advertise my application to vary (section 34 of the Licensing Act 2003)
- I understand that if I do not comply with the above requirements my application will be rejected

Part B4 – Signatures (please read guidance note 16)

Signature of applicant (the proposed current premises licence holder) or applicant's solicitor or other duly authorised agent. (See guidance note 17) If signing on behalf of the applicant please state in what capacity.

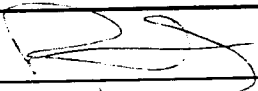
Signature	
Date	19 July 05
Capacity	

Where the premises licence is jointly held signature of 2nd applicant (the proposed current premises licence holder) or 2nd applicant's solicitor or other authorised agent. (please read guidance note 18) If signing on behalf of the applicant please state in what capacity.

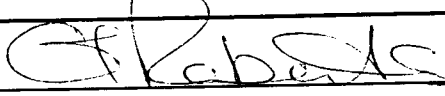
Signature	
Date	19 July 2005
Capacity	

Contact name (where not previously given) and address for correspondence associated with this application (please read guidance note 19)

Post town	Post code

Form of consent given by the person whom the applicant wishes to be the premises supervisor

Peter John Roberts [insert first names and surname of prospective premises supervisor] hereby consents to being named as the premises supervisor in a new licence granted under paragraph 4 of Schedule 8 to the Licensing Act 2003 to Peter John Roberts [insert full name of applicant] in respect of the application to convert an existing justices' licence held by the applicant/where the holder of the licence has consented to the application being made by the applicant [delete as applicable] for The Crown Inn Old Christchurch Road Evesham, Wiltshire, Hants SO41 0JJ [insert name and address of existing licensed premises] if that application is successful.

Signed 

Dated 8 June 2005

BECAUSE PREMISES LICENSED APPLICANT IS IDENTICAL TO JUSTICES LICENSEE 2ND CONSENT FORM IS NOT REQUIRED

**IN THE COUNTY OF HAMPSHIRE
GRANT CERTIFICATES**

Date of Session : **4th July 2005**

Permit/Licence No : **88**

Liquor Type : **ALL INTOXICATING LIQUOR**

Licence Holders :

**Christine Tania Roberts
Peter Roberts**

Name & Address of Premises :

**CROWN
Old Christchurch Road
Everton
Lymington
Hampshire SO41 0JJ**

Owner : **Laurel Pub Company Limited**

JUSTICES' ON LICENCE

THE LICENSING JUSTICES hereby grant by way of TRANSFER to the above applicant this JUSTICES' ON LICENCE authorising the applicant to sell by retail at the above premises, in substitution of the previous licence holder, the type of intoxicating liquor stated for consumption either on or off the premises.

This Licence is granted subject to the conditions and undertakings (if any) endorsed below and shall have effect from the date hereof until the 4th April, 2007

Given under the official stamp of the Licensing Justices which is hereto affixed under their authority by me.



Clerk to the Licensing Justices'

I, IAN DAVIS, Solicitor of Scott Bailey, 63 High Street,
Lymington HEREBY CERTIFY this to be a true copy of the
relevant page of the original document.



**IN THE COUNTY OF HAMPSHIRE
LICENSING DISTRICT OF NEW FOREST**

Sitting On : 4th July 2005

SUPPER HOURS CERTIFICATE

Premises : CROWN (Prem No: 79)
Old Christchurch Road
Everton
Lymington
Hampshire SO41 0JJ

Section A Applies Section B Applies

Part of Premises :
as detailed on the plans deposited with the licensing justices

THE Licensing Justices hereby certifies that the above premises are structurally adapted and bona fide used or intended to be used for the purpose of habitually providing for the accommodation of persons frequenting the premises substantial refreshment to which the sale and supply of intoxicating liquor is ancillary.

By Order of the Court.



I, IAN DAVIS, Solicitor of Scott Bailey, 63 High Street,
Lymington HEREBY CERTIFY this to be a true copy of the
relevant page of the original document.

Ian Davis

**LOCAL GOVERNMENT (MISCELLANEOUS PROVISIONS) 1982
(AS AMENDED)
ANNUAL INDOOR PUBLIC ENTERTAINMENT LICENCE**

NUMBER 405

The New Forest District Council of Appletree Court, Lyndhurst, Hampshire as the Licensing Authority under Section 1 of the Act DO HEREBY RENEW the annual licence, as detailed below, until the same shall be sooner revoked, subject to the terms and conditions set out in the regulations made by the Council, as amended or supplemented by the special conditions set out in the schedule hereto:

Name of person to whom the licence is granted: Mr P J Roberts

To keep and use the premises situate and known as: Crown Inn
Old Christchurch Road
Everton
Lymington
Hampshire
SO41 0JJ

Period for which the licence is granted: **Starting:** 01 April 2005
Expiring: 31 March 2006

SCHEDULE

1. Permitted Hours

For the permitted hours there shall be substituted the following:-

Days	From (Hrs)	To (Hrs)	Period
Friday	2030	2230	January to December
Sunday	2000	2200	January to December

A maximum of 12 events per year only is permitted

Only one event in any one month is permitted

I, IAN DAVIS, Solicitor of Scott Bailey, 63 High Street, Lymington HEREBY CERTIFY this to be a true copy of the relevant page of the original document.



Disability Helpline
01425 656096

Minicom/Text: 023 8028 5415

Persons Admitted:

include performers, presenters, employees and customers

The number of persons admitted at any entertainment shall not exceed:

Area or Room	Maximum Numbers	
	Seated	Dancing
Bar/Dining Areas		120

Total Capacity 120

3. Additional Conditions:

These conditions are in addition to the Standard Conditions and are contained in the attached Schedule Number(s)

113

Date issued: 10 March, 2005

A.R

A Righton
Assistant Director (Environmental Health)

(L:/Letters/PubEnt/Licences/Indoor AnnLicadcon renew

I, IAN DAVIS, Solicitor of Scott Bailey, 63 High Street, Lymington HEREBY CERTIFY this to be a true copy of the relevant page of the original document.

.....
Ian Davis

LOCAL GOVERNMENT (MISCELLANEOUS PROVISIONS) 1982
(AS AMENDED)
ANNUAL INDOOR PUBLIC ENTERTAINMENT LICENCE

ADDITIONAL CONDITIONS

LICENCE NO: 405

Period for which the licence is granted	Starting:	01 April 2005
	Ending:	31 March 2006

113. NOISE CONTROL

- 113.1 Folk and jazz entertainment only is permitted.
- 113.2 The mechanical air vent in the wall at the side of the premises marked "A" on the attached plan must be fitted with a hood or cover when public entertainment functions take place to prevent noise outbreak.
- 113.3 An insulated board should be placed into the window recess of the fixed glazed window in the wall marked "A" on the attached plan when public entertainment functions take place to prevent noise outbreak.
- 113.4 All entrance doors to the premises and windows must be kept closed during the course of all licensable public entertainment functions.

I, IAN DAVIS, Solicitor of Scott Bailey, 63 High Street,
Lymington HEREBY CERTIFY this to be a true copy of the
relevant page of the original document.



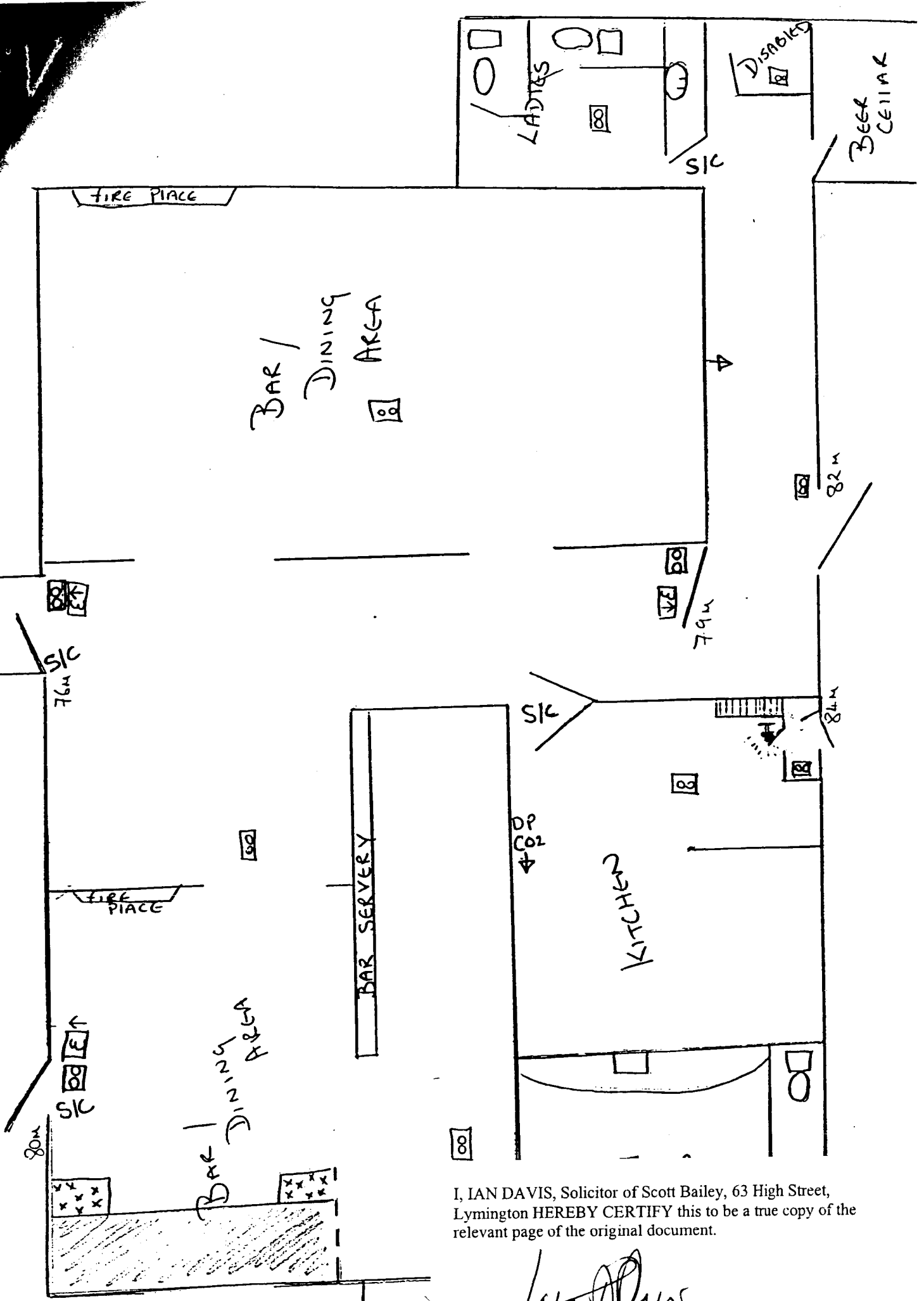

I, IAN DAVIS, Solicitor of Scott Bailey, 63 High Street, Lymington HEREBY CERTIFY this to be a true copy of the relevant page of the original document.

Ian Davis

(A)

Scott Bailey

Solicitors & Mediators

63 High Street Lymington Hampshire SO41 9ZT
Tel: 01590 676933 Fax: 01590 679663 DX: 34054 Lymington
Email: law@scottbailey.co.uk Website: scottbailey.co.uk

New Forest District Council
Licensing Services
DX 123010
Lyndhurst 2

Our Ref: ID/ED/R1130/1
Your Ref:
Date: 5 September 2005

Dear Sirs

**RE: Application Premises – Conversion & Specification DPS & Variation
(Transition)
Application reference DS/PREM/CONV/DPS VAR/08 2005/Crown Inn
Crown Inn Everton Old Christchurch Road Everton Lymington**

Thank you for your letter of the 1st September, the contents of which we note.

Please find enclosed a copy of the advert inserted in the Lymington Times and Notice of Application posted in the window of the premises, based on the date the original application was re submitted to you on the 27th July 2005.

Yours faithfully,

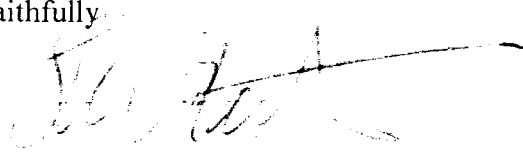

Partners: I D S Davis Mrs S L Sutherland** N P Jutton Ms S Unsworth
Solicitors: Barbara Robins James Burford Dinshaw Printer[†]
Pamela Francis F.I.L.E.X.

* Member of the Law Society Family Law Panel (Advanced) † Resolution Accredited Specialist
* Mediator & Collaborative Lawyer Regulated by the Law Society



34

LICENSING ACT 2003

NOTICE OF APPLICATION FOR VARIATION OF EXISTING JUSTICE LICENCE UNDER THE LICENSING ACT 2003

Peter Jon Roberts and Christine Tania Roberts, licensees **applied to the New Forest District Council on 27th July 2005 for a licence to use the premises at The Crown Inn Old Christchurch Road Everton Lymington Hampshire SO41 0JJ for the sale and supply of alcohol for consumption on and off the premises between the hours of 10.30 am to 01.00am 7 days a week and the provision of regulated entertainment between the hours of 20.30 – 22.30 Monday to Saturday and 20.00 – 22.00 Sunday. This amounts to a variation from the existing operation hours of 10.30am to 11.30pm 7 days a week.**

Representations should be made to the The Licensing Department New Forest District Council Appletree Court Lyndhurst Hampshire SO43 7PA.

Persons wishing to inspect the Licensing Register may do so at the above address. It is an offence to knowingly or recklessly make a false statement in connection with an application which carries a maximum fine of £5000

**LICENSING ACT 2003 PUBLIC NOTICE OF
APPLICATION FOR VARIATION OF AN EXISTING
JUSTICES LICENCE UNDER THE LICENSING ACT 2003**

**APPLICATION HAS TODAY BEEN MADE TO THE
COUNCIL FOR THE ABOVE LICENCE BY:**

**Name of Premises: THE CROWN INN
Address of Premises: OLD CHRISTCHURCH ROAD
EVERTON LYMINGTON HAMPSHIRE SO41 0JJ**

DATE: 27 July 2005

**FOR: The sale and supply of alcohol for consumption on and
off the premises and the provision of regulated entertainment.**

**PROPOSED HOURS OF OPERATION: 10am to 01.00am
Monday Tuesday Wednesday Thursday Friday Saturday and
Sunday for sale of alcohol. 20.30 -22.30 Monday to Saturday
and 20.00 – 22.00 Sunday for the provision of regulated
entertainment.**

**REPRESENTATIONS SHOULD BE MADE IN WRITING
WITHIN 28 DAYS OF THE ABOVE DATE TO: LICENSING
SERVICES, NEW FOREST DISTRICT COUNCIL,
APPLETREE COURT LYNDHURST HAMPSHIRE SO43
7PA**

**Persons wishing to inspect the licensing register may do so at
the above address between the hours of 09.00 – 17.00 Monday
to Friday**

**It is an offence to knowingly or recklessly make a false
statement in connection with an application which carries a
maximum fine of £5000**

Rejected
190

* Agreed amendment

A la Cador

From: Verity Fletcher
Sent: 11 August 2005 16:17
To: Licensing e-mail address
Cc: Ann Chester
Subject: Consultation - ~~Crown Inn, Everton~~ †

Presuming the conditions on the current PEL, and the changes e-mailed from the applicant (below) are applied to the new licence, I have no objections.

Verity Fletcher
 Environmental Health Officer
 Environmental Protection

New Forest District Council, Appletree Court, Lyndhurst, Hampshire, SO43 7PA
 Tel: 023 8028 5594
 e-mail: verity.fletcher@nfdc.gov.uk

E-mail from applicant:

Dear Mr Hetherington

RE: The Crown Inn Everton Application for conversion and simultaneous conversion of existing licence to a premises licence.

I refer to my telephone conversation of this afternoon with Verity Fletcher of the Environmental Health and Noise Control department. The Crown Inn has an outside garden, and is seeking to extend its opening hours to 1am. In order to satisfy the requirements of avoiding noise pollution and disturbance to surrounding residents, it is agreed that a proviso be placed on the licence that the outside garden will not be made available for consumption of alcohol after 23.00 each day.

I trust that this satisfies the relevant authorities and the four licensing objectives.

If we can be of further help please do not hesitate to contact us.

Thank you for your assistance in this matter.

Yours sincerely

Elinor Davis

A list of partners' names is open to inspection at the above address. Regulated by the Law society. This e-mail transmission is confidential and intended for the addressee only. It may contain privileged and confidential information. If you are not the person or organisation to whom it is addressed you must not print, copy, distribute, or take action in reliance on it. If you have received this transmission in error please notify us immediately by telephone or e-mail so that we may arrange for you to return it to us. We will reimburse your reasonable expenses.

VIRUSES - Whilst we use commercially reasonable efforts to check for the most commonly known viruses, we are not in the position to confirm that this e-mail and any attachments to it will be virus free and cannot accept any liability in this regard. We therefore commend that you carry out your own virus checks, particularly before opening any attachments.

15/08/2005

37

Tony Hetherington

From: Anita Young
Sent: 30 August 2005 12:04
To: Tony Hetherington
Subject: FW: Website Form: Feedback.

And another one?

Anita
Anita Young
Customer Service Supervisor
01590 646123
anita.young@nfdc.gov.uk

-----Original Message-----
From: alistair.hogg@tesco.net [mailto:alistair.hogg@tesco.net]
Sent: 29 August 2005 23:42
To: Customer Services
Subject: Website Form: Feedback.

The following details have been submitted direct from the New Forest District Council website:

Name: Alistair Hogg

Address: Little Yeovilton
West Lane
Everton
Lymington
Hants

Postcode: SO41 0JQ

Country: UK

Telephone: 01590 642863

Email: alistair.hogg@tesco.net

Comments: URGENT*URGENT*URGENT
Please pass this on to your Alcohol Licencing Department.

I am very concerned to hear that the licencees of the **Crown Inn at Everton** have applied for an extension to the existing licencing hours and additionally for a music licence.

As a local resident living very close to the Inn, I feel I must register my protest against the application.

The Music licence is wholly inappropriate for the quiet village location of the pub. The pub is surrounded by residential properties whose inhabitants include young children and elderly people whose lives and basic human rights to live and sleep in peace will be severely affected if the licence is granted.

In addition, the extension to the alcohol licencing hours is also inappropriate. As mentioned above, Everton is a quiet village. I am sure I speak for others in the village when I say that we are happy to have a pub and we are satisfied with the current opening hours. An extension of these hours is not needed, would be out of character with the village and would only lead to an increase in disturbances as people leave the pub after more hours drinking. The location of the pub would inevitably mean very real risk of an increase in the number of drunk drivers, as Everton does not have any alternative transport to match these extended hours.

I am informed that there were regular disturbances in the village and property was damaged when the opening hours at the Village Club were extended some years ago. This situation is sure to be repeated if this application is passed.

Diane Sim

From: Mia Bongers [mia@bongers.freemove.co.uk]
Sent: 31 August 2005 09:28
To: Licensing e-mail address
Subject: Licence Application Crown Inn

Dear Sirs,

I understand that my local pub, the Crown Inn at Everton, Lymington, has applied for a licence to stay open late.

My house is the 4th house from the pub and faces Old Christchurch Road.

I would like to object to this application on the following grounds:

- too many cars parked until all hours in the road; Old Christchurch Road is a busy road and quite narrow. Residents find it increasingly dangerous to cross the road as the parked cars obstruct the view. A few months ago my elderly neighbour was knocked down by a car she could not see approaching.
- an increase in noise and anti-social behaviour in the road; already I had branches pulled off my trees, beer cans thrown over the wall and people urinating on my gate.
- it seems inappropriate to have a late pub in a quiet village; we are not a city centre or a hoopla place.
- in a more general sense: it seems that we, in this country, are not able to drink late in a quiet manner. I believe that history shows that more opportunity means more abuse of alcohol - is this the way we want to go?

I hope that my objections will be accepted.

With thanks

Mia Bongers
Studio House
12 Yeovilton Close
Everton SO41 0JS
Tel 644012

This e-mail has been scanned for all viruses by Star. The service is powered by MessageLabs. For more information on a proactive anti-virus service working around the clock, around the globe, visit: <http://www.star.net.uk>

Licensing Officer
Appletree court
Lyndhurst
S043 7PO

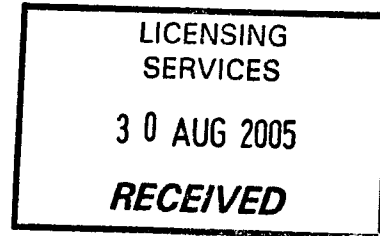

Dear Sirs,

Re: Crown Public House, Everton.
Licensing application.

I am writing to oppose the application of the proposed licence, which includes a large proportion of increased opening hours and music.

It is a country pub in a rather sedate old village at the end of a row of listed buildings, very residential with high priced properties. All their owners pay high community rates for living in such a nice ambient village.

This proposal could possibly attract a proportion of young and possibly out of control youngsters displaying bad behaviour and creating disruption in our village, and causing more traffic congestion than we have already, at the present opening times, therefore undermining another pleasant rural area.

I know from passing other local pubs and surrounding areas, that you get noisy crowds of unruly youngsters with police in attendance. This could be in our village. Please consider this, and not let this happen to our village.

The advice notices for this new licence have been slyly hidden in various parts of the pub, but should really be more prominently displayed to enable all villagers to express their Opinions on this matter, which is, i.e. massive objections.

None of us in the village are killjoys, we all enjoy pubs and music, but at amenable hours. There is a club almost next to the pub and they have music, yet they seem respectful of the surroundings and the members are regulated.

Yours truly,

Kenneth J Shelley.

A handwritten signature in black ink, appearing to read "K. Shelley". The signature is written over the typed name "Kenneth J Shelley".

Woodley
10 Old Christchurch Road, Everton
Lymington, Hampshire. SO41 0JJ

31.8.2005

Dear Sirs

With reference to the application for late opening hours by the Crown Inn at Old Christchurch Road, Everton I am writing to you to register my objection.

I live very close to the Crown Inn and the the extended opening hours could lead to an increase of crime and disorder and cause a public nuisance in the village.

There is also a clear threat to public safety as parking in Old Christchurch Road is already totally congested for many hours of the day and always in the evenings by the visitors to the pub and also to the club. Residents in the road have to pull out into the path of oncoming vehicles with very restricted vision.

The village of Everton is a quiet residential area which would be spoilt and due to the above points threaten the safety and welfare of the residents and children.

I would be grateful if these points of great concern could be considered for which I have been unable to establish the timing.

1. There is no date on the notice at the Crown Inn
2. On telephoning the licensing office last week I could not obtain this date but was advised that the application had been rejected. This information was conveyed to residents close to the Crown Inn.
3. Yesterday I was told that if I wished to register any objections I should do so very quickly.

Yours faithfully

P.M. Sainsbury-Brown

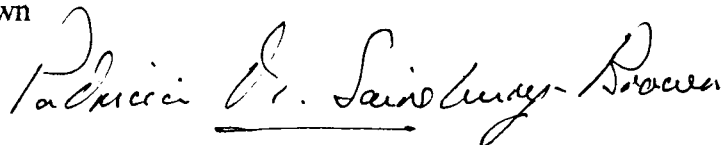

New Forest District Council
Appletree Court
Lyndhurst
SO43 7PA

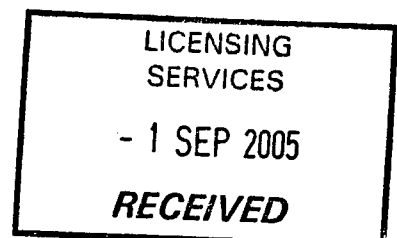

25 August 2005

Licensing Officer
Appletree Court
Lyndhurst.
SO43 7PO



Dear Sir,

re:CROWN PUBLIC HOUSE. EVERTON.
LICENSING APPLICATION

I am writing to oppose the application of the proposed licence which includes a large proportion of increased opening hours and music. This is a country pub in a quiet old village at the end of a row of listed buildings, very residential with high priced properties. All their owners pay high community rates for living in such a nice ambient village.

This proposal will inevitably attract a proportion of young, possibly out of control youngsters who contribute nothing to the village except shouting, bad behaviour, traffic congestion even worse than at present and will seriously undermine yet another pleasant rural area.

On Sat 20th, late night, I travelled through Southampton, Bittern and Lymington and outside 3 pubs were crowds of noisy young people with police in attendance at Lymington..please consider what this could do to our village..please do not let it happen.

The publican, I think, knows he will not be popular with this proposal as the so called notice to advise residents is virtually unseeable, being hidden in a small top of a window behind flower pots and picnic tables and it should be posted in a much more prominent position to enable all villagers to have their say..ie massive objections.

We are not killjoys, we all enjoy pubs and music but in the right place and amenable hours..we have the Club almost next to the pub and they have music but seem very respectful of the surroundings and also the members are regulated.

The locals are fighting this application tooth and nail, this is upsetting village life but, whatever goes through, if it includes music, we would fight for a noise monitor and I am sure the police would not be happy about complaints about disturbances. We have a new development very near the pub, properties costing £365,000. I hope the Agents are happy to advise prospective buyers of this application. I have advised both agents involved.

Yours truly,

J. Day
42

Diane Sim

From: Graham Bowden [gjb@phys.soton.ac.uk]
Sent: 31 August 2005 12:13
To: Licensing e-mail address
Cc: G.J.Babbage@soton.ac.uk
Subject: Crown Inn Everton, Lymington

To: licensing@nfdc.gov.uk

Old Mellow
6 Old Christchurch Road
Everton
Lymington
Hants
SO41 OJJ
Tel. 01590 645186
email address gjb@phys.soton.ac.uk
31/8/05
Dear Sir/Madam

We wish to lodge an objection to the granting of extended opening times, for music and drinking, to the Crown Inn, Everton Village.

Our reasons are as follows:

1. Everton is a quiet village where many people are generally in bed before 11:00 pm. We see little need for extended music and drinking to 1:00 pm.
2. The Everton and Lymore Club already has regular music nights. We believe that one venue is enough for a small village.
3. Later drinking hours could encourage yobbish behaviour. We have already had incidents of bottles, glasses, rubbish being thrown into gardens along the Old Christchurch Rd.
4. Parking already causes problems along Old Christchurch Rd. We do not relish extra noise associated with cars leaving in the early hours. (There is no public transport.)

We appreciate that Mr Roberts may not want to operate extended hours all of the time. But should he move on, a precedent will have been set. A new incoming Landlord may choose to use an extended licence to the full.

We remind you that Everton is a quiet village, and the vast majority of villagers/pensioners wish to keep it that way. Yours Faithfully,

Prof. and Mrs G. J. Bowden

PS. The Crown Inn application was un-dated.

This e-mail has been scanned for all viruses by Star. The service is powered by MessageLabs. For more information on a proactive anti-virus service working around the clock, around the globe, visit: <http://www.star.net.uk>

Licensing Services
New Forest District Council
Appletree Court
Lyndhurst SO43 7PA

Mr & Mrs G W Ferguson
11 Old Christchurch Rd
Everton
Lymington SO41 0JJ

25-08-05

Ref. The Crown Inn, Everton, variation of License application.

Dear Sirs,

We would like it known that we are fervently against any change to the license of the above Inn. We are a small village and this would encourage "drinkers" to drop in on there way home, to consume more alcohol and create noise that is, so far, reasonable.

The Application for the provision of regulated music is also not acceptable as we are already suffering from an abundance of sound from the Everton & Lymore Club, which, as you know, is next door. Also the Notice in question is not "Dated" Does this make the application illegal??

We await your reply with interest.

Yours.

G Ferguson
G Ferguson

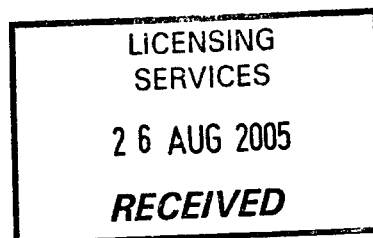

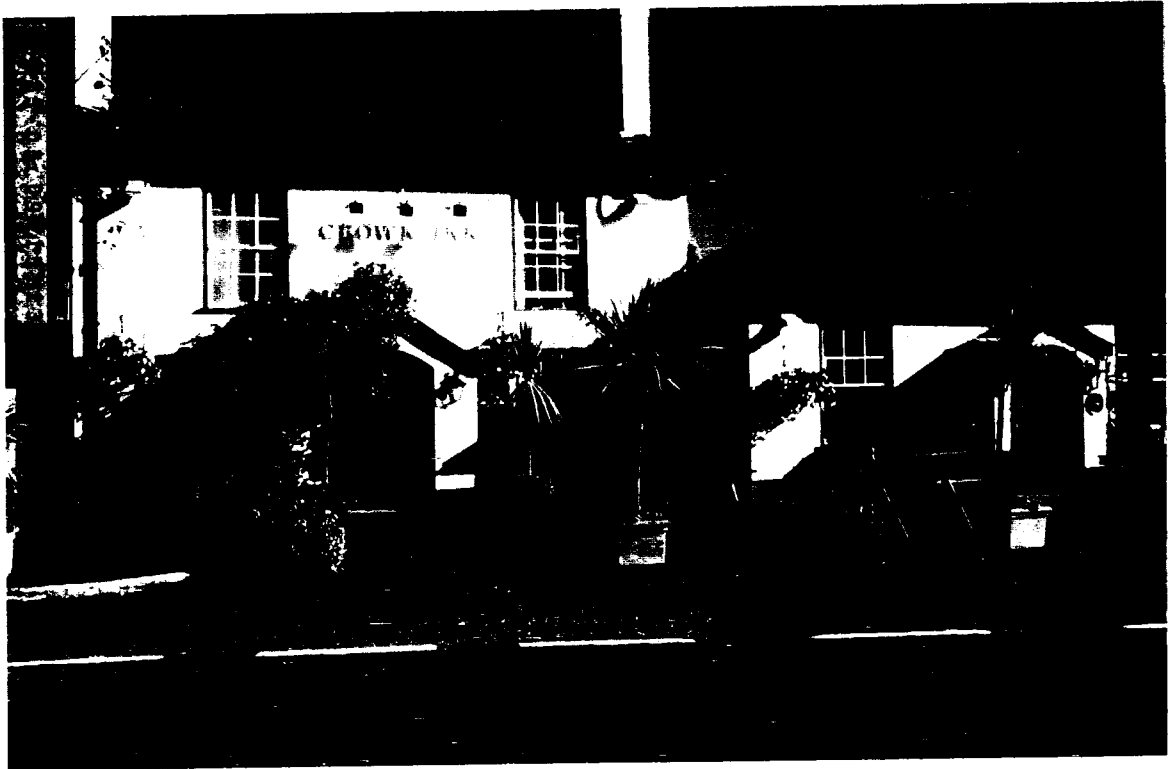
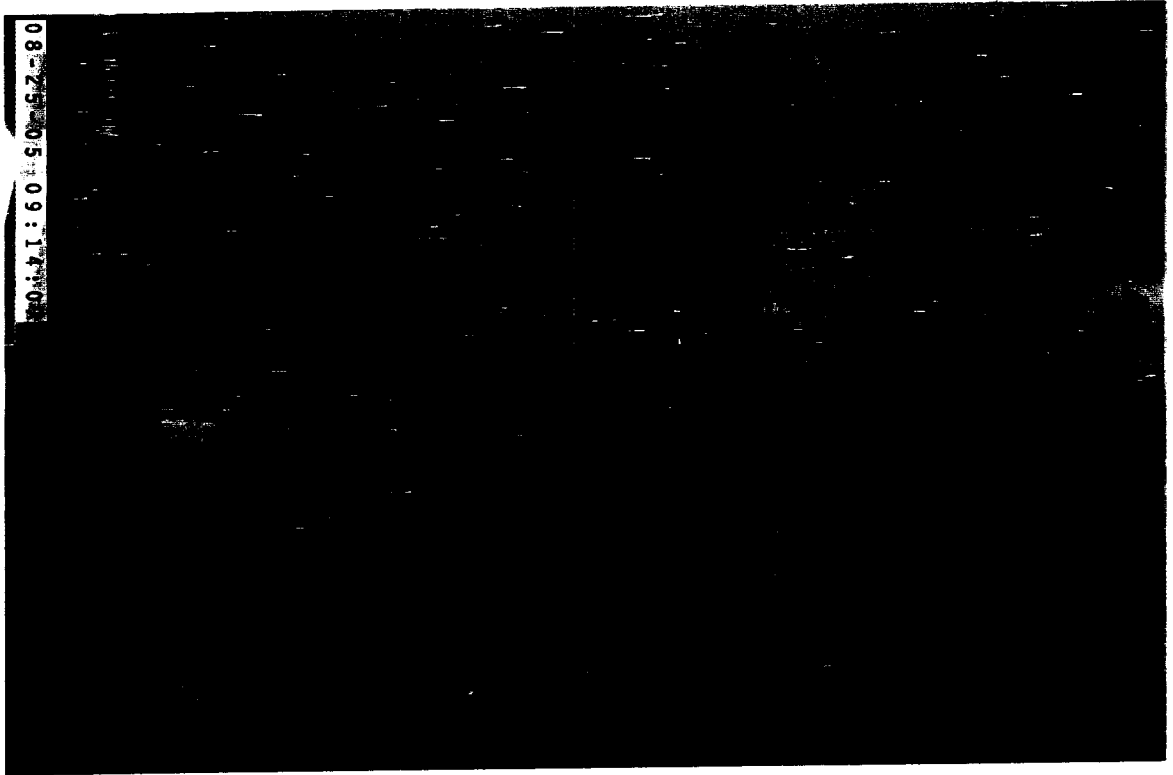

29/8/05

M. G. & P. M. Johnson
Chanctonbury
1A Firmount Close
Everton, Lyminster
Hants. SO41 0JN
Tel: 01590 644573

Licensing Department
NFDC
Lyminster.

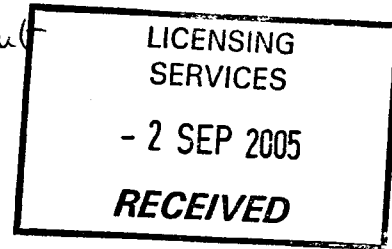

Dear Sir,

We are writing to object to the application by the Crown Inn, Everton, to extend their opening hours.

Everton is a quiet country village and those who choose to live here have done so just because it is, and would like to feel it stays that way.. Later opening hours would inevitably lead to undesirables coming into the village to avail themselves of the Crown's facilities. Not only that we live at the side of the Crown

and we already have problems
with their patrons blocking our road,
and Old Christchurch Road.

If a pub is in the centre of a town
where people come out of theatres
and cinemas late at night and
want a drink, this would cause
no extra traffic or noise as these
people would be there already.

Yours. faithfully.

M. & P. Johnson.

**EAST HOUSE EAST LANE EVERTON LYMINGTON
HAMPSHIRE SO41 0JL**

Tel: 01590 643380

E-mail: judyandron@hotmail.com

1 September 2005

Licencing Dept
New Forest District Council
Appletree Court
LYNDHURST
Hants.
SO43 7PA

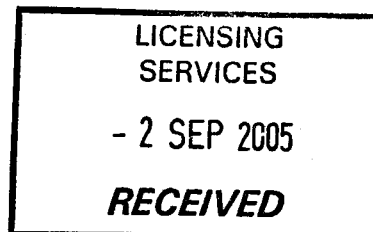

Dear Sirs

THE CROWN INN EVERTON LYMINGTON HANTS

We understand that the Crown Inn has applied for a licence for extended opening hours.

Being pensioners, we are very disturbed about this application. Our property is close to the garden and car park and we already get considerable noise from the garden at times. If the hours are extended we are concerned that this will cause further noise and public nuisance to the residents of Everton, due to rowdy behaviour from customers as a result of excess drinking due to longer opening hours. My husband is disabled and does need to have undisturbed sleep. It is a known fact that excess drinking does lead to vandalism, crime and disorder. We never see police here in Everton and it is a concern that there are not enough police to enforce orderly behaviour in our currently quiet village.

My husband is disabled and does walk with a walking frame in the village on his own during the day. However, The Crown could attract a younger element of people, if the licencing hours are extended, which in turn could pose a threat to his welfare and safety. It is good for his well-being and health to be independent and take exercise; I feel this may have to be curtailed if we get younger people taking excess alcohol and becoming abusive and threatening in the village. This situation would also apply to other residents of Everton. In the interests of security for residents, I would suggest that the street lighting in East Lane, Centre Lane and West Lane should be improved, if this licence is granted, as at present it is very poor.

The majority of Everton residents are retired and came to live here because of its quiet location, we do not want to encourage our village to become a place of crime and disorder, where we feel threatened and unable to lead a normal independent life.

Yours faithfully

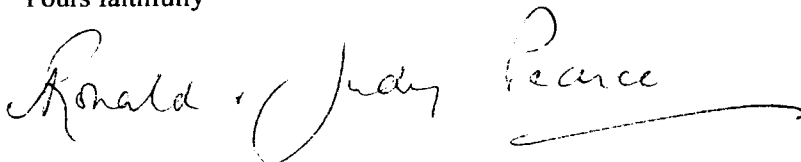

Ronald and Judy Pearce

9 2ND CHRISTLURCH ROAD

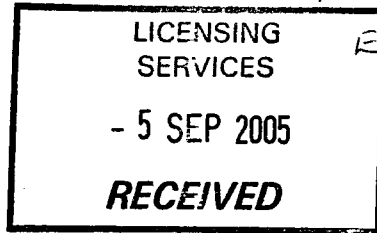

EVERTON

SO41 0JJ

25 8. 05

Dear Sir

re: Crown Public House Everton,
Licensing Application.

We are writing to oppose the application for increased opening hours and increased music.

This is a country pub in a very residential area.

The pub already has a license for music one night a month which is bad enough. Last time they had a music night the noise was so bad we actually used our video camera to record it. We also have to suffer noise from Everton Club.

Parking is bad now as customers to the pub park all along

one side of Old Churchward Road
making it virtually a single width
road. This can only get worse.

The pubican obviously knew this
application would not be popular
as the notice to advise residents
is positioned in a small top
window behind flower pots and
picnic tables. Surely it should
be posted in a more prominent
position.

Yours truly

MH + H.G. TASKER

MH + H. G. TASKER